

## TERMORESISTENZA CON USCITA CAVO A 90° RESISTANCE THERMOMETER WITH CABLE EXIT 90°

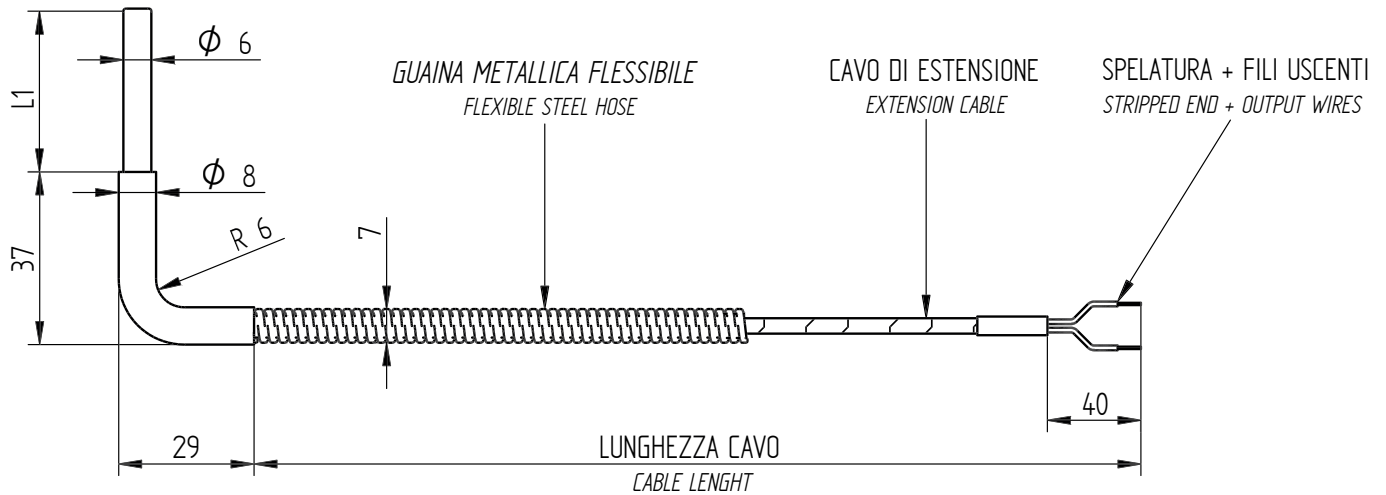

LA TEMPERATURA DI LAVORO DELLA TERMORESISTENZA È IN FUNZIONE DEL TIPO DI CAVO UTILIZZATO  
THE RESISTANCE THERMOMETER'S WORKING TEMPERATURE DEPENDS ON THE TYPE OF CABLE USED

CAVO DI ESTENSIONE ISOLATO INSULATED EXTENSION CABLE	
TTS	Isolamento fibra di vetro siliconato + Maglia rame stagnato (-25° C / +350° C) Fibre glass insulation + Tin plated copper braid (-25° C / +350° C)
GS	Isolamento gommasilicone + Guaina gommasilicone (-60° C / +180° C) Silicon rubber insulation + Silicon rubber sheath (-60° C / +180° C)
MFS	Isolamento Hyflon MFA + Guaina gommasilicone (-40° C / +200° C) Hyflon MFA insulation + Silicon rubber sheath (-40° C / +200° C)

TERMORESISTENZA RESISTANCE THERMOMETER	
PT100	100 Ω a / at 0° C
Classe B Class B	± 0,30° C a / at 0° C

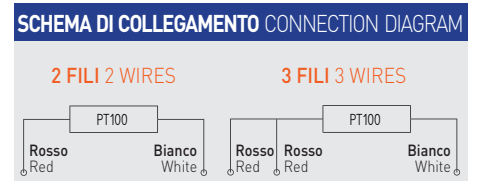

TOLLERANZA DELL'ELEMENTO SENSIBILE SECONDO IEC 751 CLASSE B  
SENSITIVE ELEMENT'S TOLLERANCE ACCORDING TO IEC 751 CLASS B

LUNGHEZZA TUBETTO (L1) TUBE LENGTH (L1)	MATERIALE TUBETTO TUBE MATERIAL	MATERIALE GUAINA METALLICA METALLIC SHEATH MATERIAL
40 mm	Acciaio inox AISI 303 Stainless steel AISI 303	Acciaio zincato Galvanized steel

### ESECUZIONE TERMINAZIONE EXECUTION TERMINATION

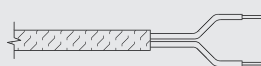

Conduttori liberi  
Flyng leads

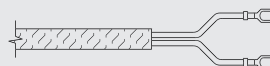

Capicorda  
Lugs

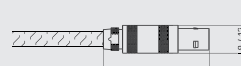

Connettore Lemo  
Lemo connector

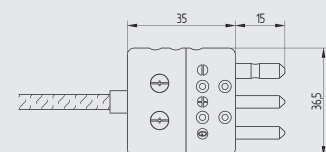

Connettore standard  
Standard connector

Le informazioni contenute nella presente scheda tecnica non sono vincolanti. Crei riserva il diritto di apportare modifiche senza preavviso alcuno.  
The informations contained in this technical data sheet are not binding. Crei reserves the right to make changes without prior notice.